



visionLINE™
FIREPLACE & FLUE SYSTEMS

FIREPLACE & FLUE SYSTEMS

VisionLINE

Modern cutting-edge designs incorporated into durable and made to last products make your investment in VisionLINE products a lifetime relationship.

VisionLINE design, creates and manufactures premium, European style fireplaces, venting systems and fireside accessories to meet the unique requirements in the Australian market.

We are proud to be at the forefront of fireplace and flue system technology, particularly when it comes to safety in your home, as well as efficiency. At VisionLINE fireplaces, we use a kiln brick inside our units due to its thermal mass and durability. Typically, European style fireplaces sold in Australia use a material called Vermiculite, which is a thermally efficient and lightweight compressed ceramic material. The problem with this material when used in fireplaces is that it is fragile and prone to breaking if the user is not careful when placing wood into the fire to re-fuel. Kiln bricks are clay based, extremely dense and heavy and best suited in situations where impact with a dense Australian hardwood is likely.



Scan to view our
VisionLINE AIR Flue
walkthrough video



TAURUS IB



TAURUS

All VisionLINE wood fireplaces are outside air kit ready. An outside air kit provides air for combustion to the fireplace by drawing oxygen from outside the home.

This improves the performance of the fireplace in properties that are particularly tightly-constructed or well insulated. All units are also tested and approved with VisionLINE Safety Vent AIR flue which is a room sealed insulated flue providing ultimate efficiency for your home while reducing wind noise by up to 95%. This unique flue can also draw combustion air to the fireplace connecting to outside air, making your VisionLINE fireplace a balanced flue wood fire, perfect for passive or closed envelope homes.



TAURUS DS

VISIONLINE

Taurus

ALSO
AVAILABLE IN



A feature-rich slow combustion unit, the VisionLINE Taurus unit encompasses style and class with efficient, radiating heat.

Designed with Australian homes in mind, the Taurus is built to burn Australian hardwood thanks to its durable construction and use of high grade materials.

Accompanied by a large heating capacity and long burn time, unique to landscape fireplaces in Australia – the VisionLINE Taurus unit will emanate warmth and sophistication, transforming any space with its sleek and modern design.

Key Features:

- Heavy duty firebrick baffle
- Steel construction with self-cleaning white hue brick liners
- Self-closing door with dual latching mechanism
- Deep internal ash lip to prevent spillage
- Available configurations
 - Freestanding (with fan option)
 - Zero clearance (installation into timber stud frame)
 - Insert into brick fireplace
- Heating capacity to suit a large home
- Three point combustion delivers large heating capacity while burning less wood
- Long burn time
- Large full glass door



TAURUS IB WITH



TAURUS

INBUILT ZC



BURN TIME
Up to 12h



AVG EFFICIENCY
61%



PEAK EFFICIENCY
74%



EMISSIONS
1.3G/KG



HEATING CAPACITY
Up to 220m²



LOG LENGTH
Max 700mm

FREESTANDING



BURN TIME
Up to 12h



AVG EFFICIENCY
61%



PEAK EFFICIENCY
74%



EMISSIONS
1.3G/KG



HEATING CAPACITY
Up to 300m²



LOG LENGTH
Max 700mm

VISIONLINE

Phoenix

ALSO
AVAILABLE IN



The VisionLINE Phoenix offers a modern design with clean, sophisticated lines, powerful performance, long burn times and high heat output.

Taking its design principles from its larger counterpart the Taurus, the Phoenix is the perfect complement for any contemporary home.

Featuring a unique rear crossflow baffle system, which gives you more room for fuel with a bypass for easy starting, and optional dual fans, the Phoenix will help create a warming environment during the harshest of Australian winters.

Key Features:

- Full glass door
- Rear crossflow baffle system
- Heavy kiln brick lined firebox with ash lip
- Baffle bypass system for easy starting
- Single control to operate primary and secondary air
- Outside air ready
- Dual fan option
- 6mm Steel construction
- Available with optional wood storage pedestal
- Industry leading burn times



BURN TIME
Up to 12h



AVG EFFICIENCY
61%



PEAK EFFICIENCY
74%



EMISSIONS
1.0G/KG



HEATING CAPACITY
Up to 250m²



LOG LENGTH
Max 460mm



PHOENIX

VISIONLINE



(Insulated Zero Clearance)

Installing an inbuilt zero clearance fireplace in airtight or passive homes has never been possible — until now.

The VisionLINE IZC (Insulated Zero Clearance) Box is the first and only system designed specifically for high-performance homes, eliminating the need for ventilation and external make-up air.

Key Features:

- Fully Room-Sealed Installation and Operation**
 Patented design with no ventilation required — ideal for passive and energy-efficient homes.
- Advanced Ceramic Insulation**
 Maintains safe installation without the need for external | airflow around the fireplace or relief at the cap.
- Outside Air Integration**
 Concentric spigot seamlessly connects with the VisionLINE AFS+ system, supplying combustion air directly from outside without the need for additional piping.
- VisionLINE AFS+ Flue System**
 Fully insulated, double-wall flue allowing minimal clearances, maximum efficiency, and balanced flue operation.
- Optimised Fireplace Performance**
 Unique airflow design and dual insulated heat relief vents maximize heat output and efficiency, preventing heat loss typical of traditional ZC casings.
- BAL40 and Flame Zone (FZ) Approved**
 The only inbuilt zero clearance system certified for use in bushfire-prone areas.
- Compatible Models**
 Designed for easy connection with VisionLINE Taurus and Phoenix fireplaces.
- Superior Air Pressure Management**
 Solves air supply and pressure issues for combustion in airtight home environments. and energy-efficient homes.



AFS+ FLU SYSTEM



BALANCED FLUE TECH



ROOM SEALED FLUE & ZC CASE



BAL-FZ APPROVED



BAL-40 TESTED & COMPLIANT



INSULATED TWIST LOCK



95% WIND NOISE REDUCTION



HIGH WIND COWL



BAL-FZ TESTED & COMPLIANT

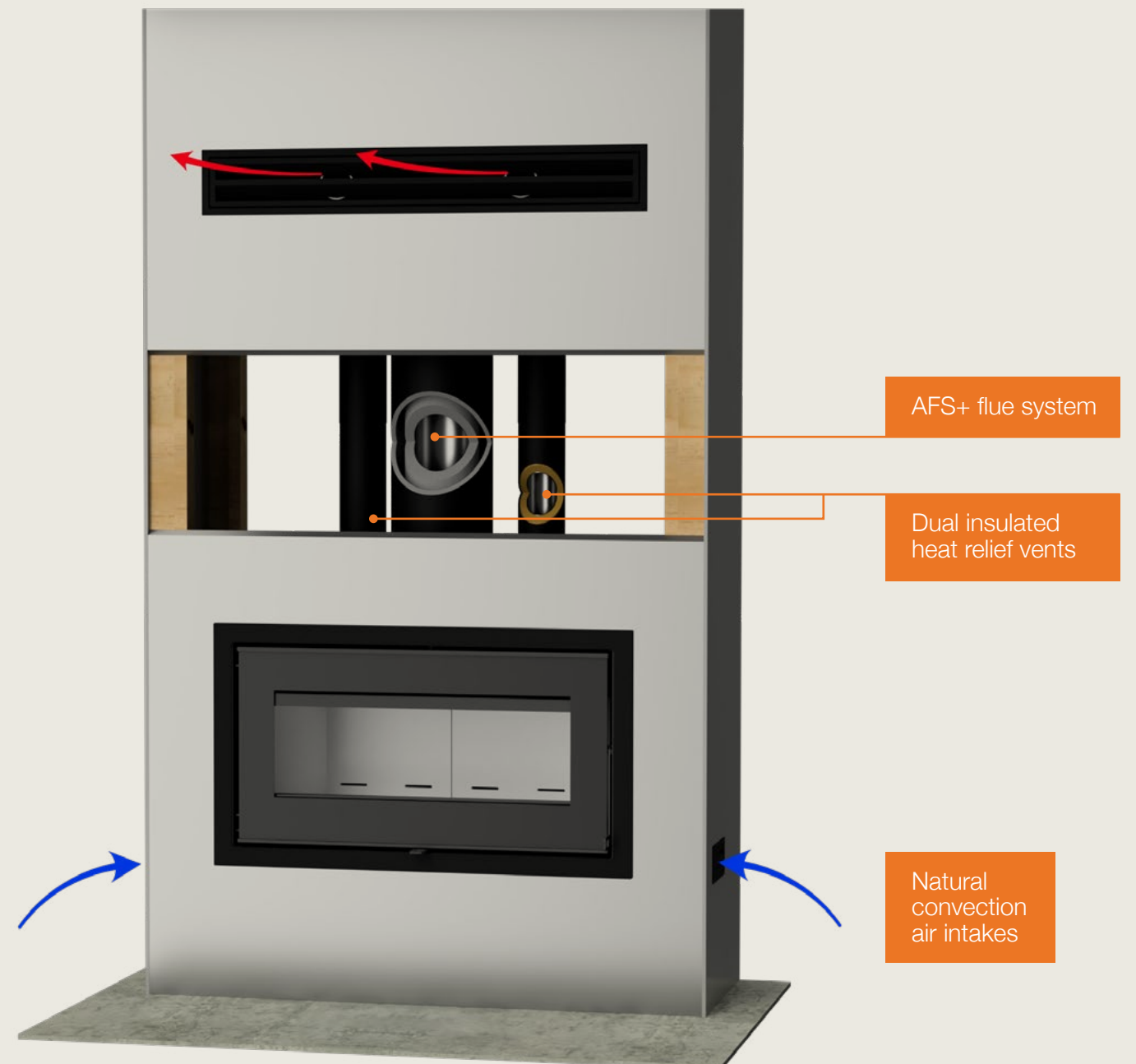
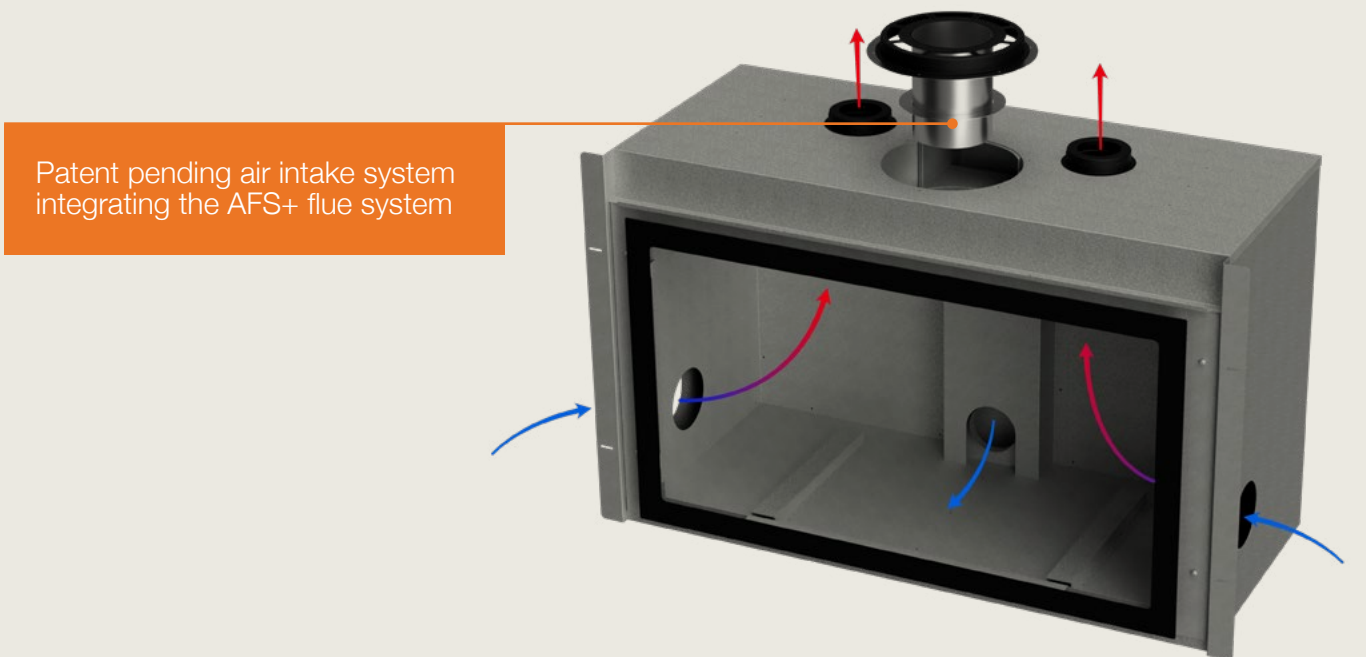

VISIONLINE

Taurus DS

The VisionLINE Taurus DS incorporates all the great features of our single sided Taurus into a double sided panoramic fireplace.

Designed from the ground up for Australia, this fireplace offers high heat output combined with long burn times while maintaining sleek European styling.

Thick steel construction combined with white hue kiln brick liners deliver incredible durability, perfectly suited to Australian Hardwood.

Key Features:

- Heavy Duty Kiln Brick Liners and baffle
- Dual self-closing doors with dual latch locking
- Built in ash lip for cleaner operation
- Primary and secondary air control
- Outside Air Ready
- Optional dual inbuilt fan pedestal
- Freestanding or Inbuilt ZC installation



Optional dual fan pedestal



TAURUS DS

INBUILT ZC



BURN TIME
Up to 12h



AVG EFFICIENCY
62%



PEAK EFFICIENCY
68%



EMISSIONS
0.8G/KG



HEATING CAPACITY
Up to 220m²



LOG LENGTH
Max 700mm

FREESTANDING



BURN TIME
Up to 12h



AVG EFFICIENCY
62%



PEAK EFFICIENCY
68%



EMISSIONS
0.8G/KG



HEATING CAPACITY
Up to 300m²



LOG LENGTH
Max 700mm

VISIONLINE

Pera

Introducing the latest addition to our collection of modern wood fired heaters, the VisionLINE Pera.

Bringing clean and efficient flames to your home, the Pera provides modern European styling in a compact space saving design.

Its sleek self-closing door and beautifully designed storage compartment is partnered with a 3 sided glass viewing experience in a compact yet robust fireplace perfect for tiny homes or small to medium living spaces.

Take the next step in wood heating, choose Pera.

Key Features:

- Useable firebox size is 250mm width x 260mm depth x 370mm height
- 10 Year Warranty
- 3 sided glass design
- Kiln brick firebox liners
- Self closing door
- Outside air ready
- Wood storage base
- Concentric spigot for balance flue available



BURN TIME
6-8h



AVG EFFICIENCY
61%



PEAK EFFICIENCY
74%



EMISSIONS
1.0G/KG



HEATING CAPACITY
Up to 150m²



LOG LENGTH
Max 300mm



PERA

VISIONLINE

Circle

Simple in design, and contemporary in style, the VisionLINE Circle wood burning fireplace melds seamlessly into any space.

For interiors where size is an issue, the minimalism of its rounded form strikes a strong impression, ideal for placement in the centre of a room. Its unique concentric spigot is perfect for passive or closed envelope homes, providing room sealed operation and outside air via the one pipe.

Clean lines, cutting edge technology and high quality materials ensure the Circle will warm and burn brightly for decades to come.

Key Features:

- Winter white hue in durable kiln brick combustion chamber
- Elegant integrated door handle
- Distinctive smokeless surface paint
- Concealed handle to operate primary and secondary air
- Full cast iron grate
- Self closing door system
- Dual latching door provides solid operation
- Black glass covered sliding drawer door
- Ready to connect to outside air via rear inlet or directly to the spigot with VisionLINE Safety Vent AIR pipe



BURN TIME
Up to 7h



AVG EFFICIENCY
61%



PEAK EFFICIENCY
68%



EMISSIONS
1.0G/KG



HEATING CAPACITY
Up to 150m²



LOG LENGTH
Max 300mm



CIRCLE

Circle

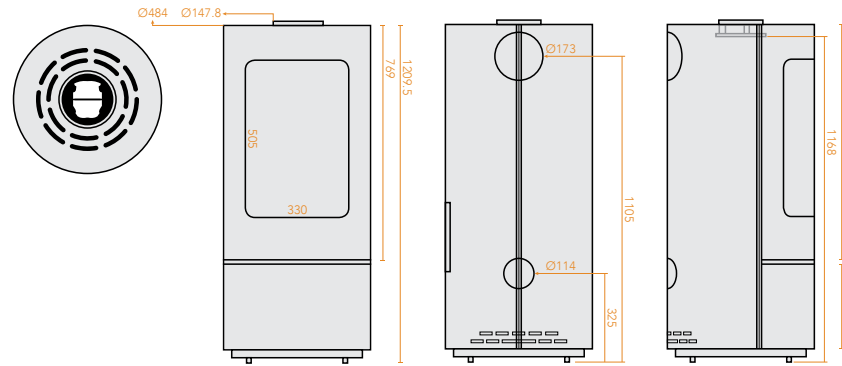

Taurus

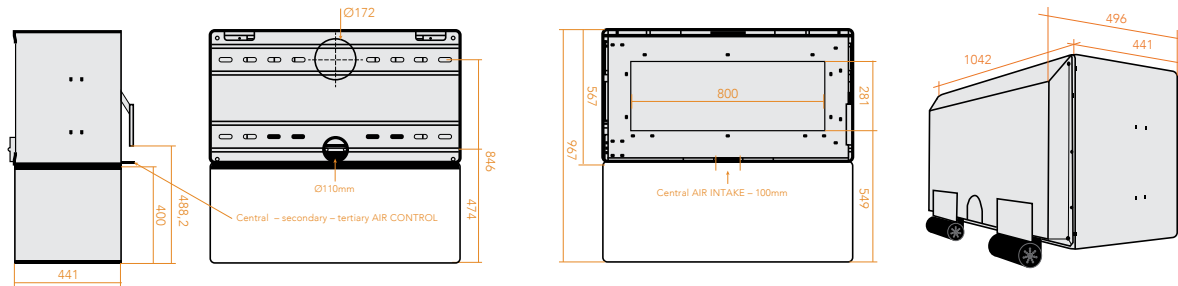

Taurus ZC hearth specs available online.

Taurus DS

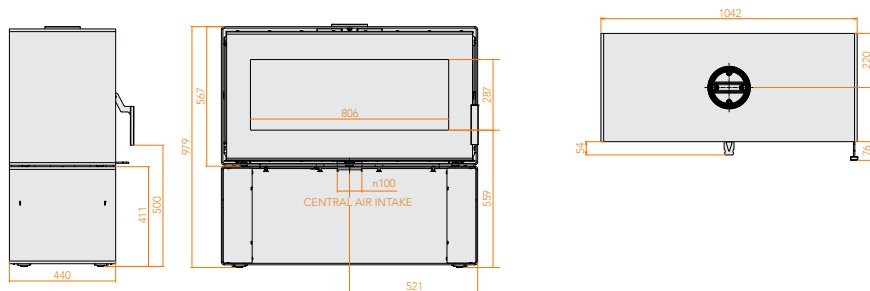

Parallel Positioning (mm)

- A** Min clearance from firebox to rear wall
- B** Min clearance from firebox to side wall
- C** Min distance from firebox opening to floor protector front
- D** Centre of flue to rear wall
- E** Centre of flue to side wall
- F** Min recommended hearth depth
- G** Min floor protector width

	Circle	Taurus	Taurus DS	Phoenix	Pera
	Solid or deco mesh	Default flue with unit heat shield and on FS base	Default flue with 8" solid or mesh CASING	8" mesh with shield	8" Solid with shield
					Default 6" with 8" solid or mesh CASING
A	125	200	1400	150	250
B	550	475	350*	425	425
C	300	300	300**	300	300
D	367	451	-	382	482
E	792	996	873	775	775
F	910	1000	1040**	1080	1180
G	700	1230	1240	930	930

*Clearance is 75mm for non projecting wall, see manual.
**When using optional pedestal base.

Phoenix

Please note: 300mm hearth projection min. when using optional wood storage base/ pedestal Corner installation requires an additional 900mm high x 180 of stainless steel flue shield fitted between mesh or solid casing and active flue.
Additional rear unit heat shield must be installed unless against a non-combustible wall.

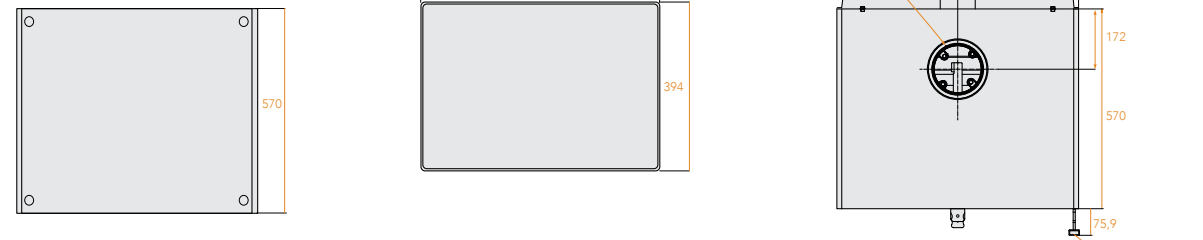

Pera

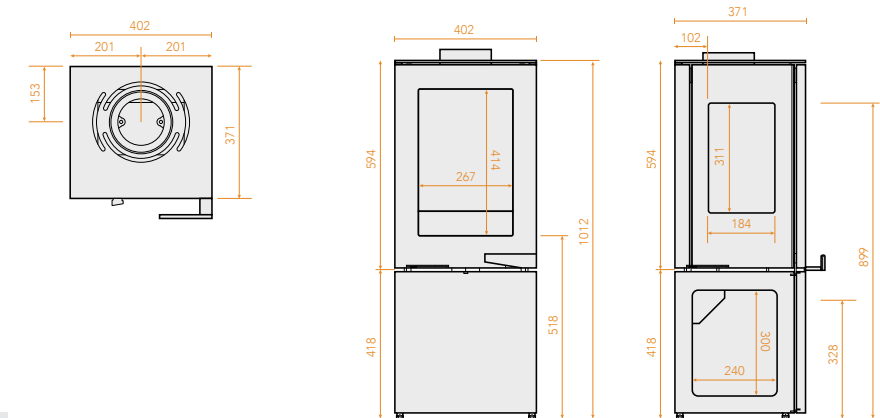

Corner Positioning (mm)

- A** Min clearance from firebox to corner wall
- B** Min depth of floor protector
- C** Min distance from firebox opening to floor protector front
- D** Centre of flue to walls
- E** Min floor protector width
- F** Corner wall to hearth front
- G** Corner of hearth to wall

	Circle	Taurus	Phoenix	Pera
	Solid or deco mesh	Default flue with unit heat shield and on FS base	8" Mesh with shield	8" Solid with shield
				Default 6" with 8" solid or mesh CASING
A	175	200	150	225
B	785	993	1030	1120
C	300	300	300	300
D	590	743	515	568
E	700	1230	930	930
F	1050	1572	1384	1448
G	555	-	727	793

*Min distance from wall to floor protector front for the PERA only.



VisionLINEFire.com.au



Designed in Australia, Made in Europe



Australian
Home Heating
Association Inc.



FIREWOOD ASSOCIATION
OF AUSTRALIA INC™